

**FLAT # 104**  
Area:- 1354.00 Sft.

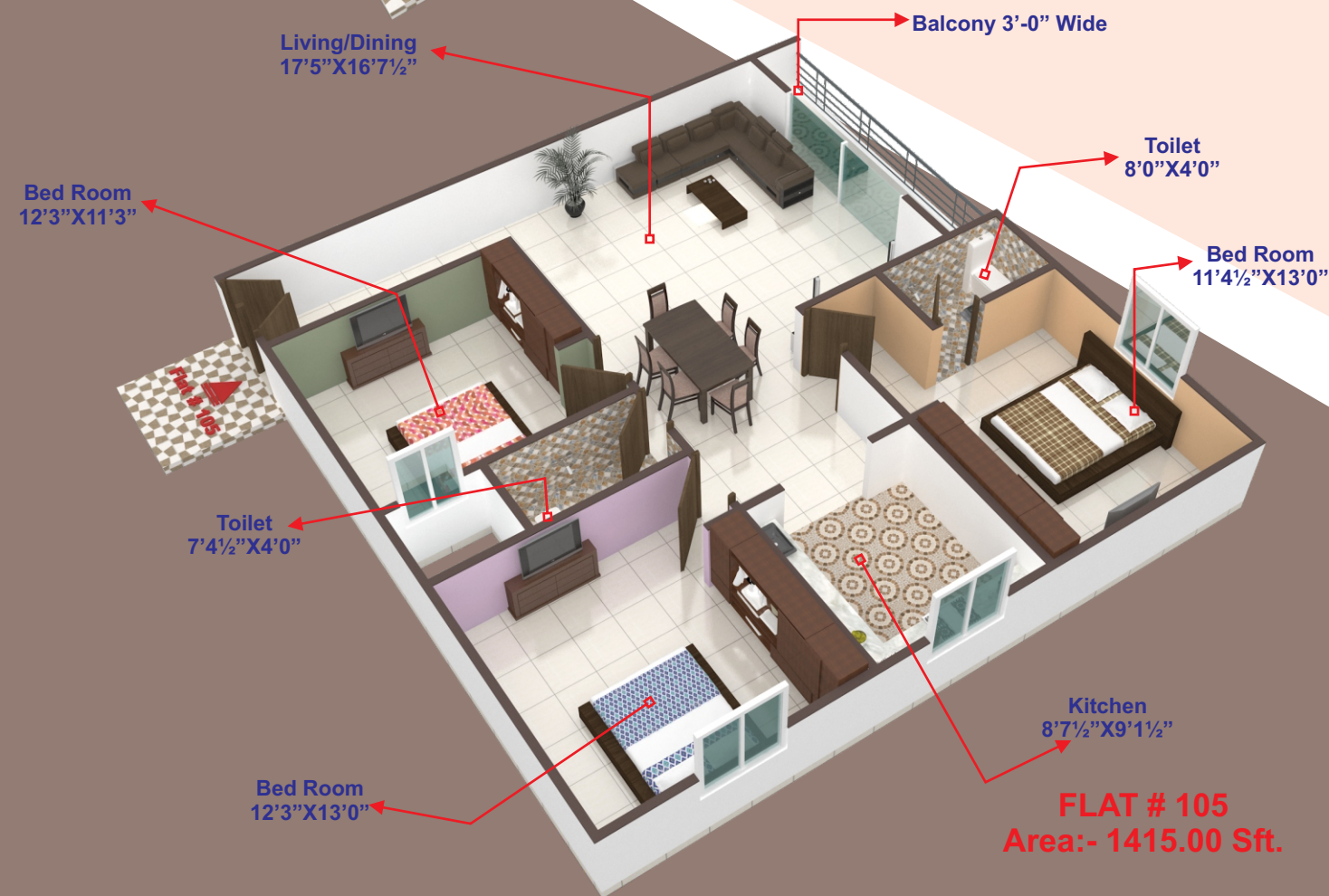

**FLAT # 105**  
Area:- 1415.00 Sft.

## Completed & Ongoing Projects



**Syed's Residency**  
@ Saidabad  
Site Co-ordinates  
17.360196, 78.513258



**Noor Residency**  
@ Saleem Nagar, Ganga Nagar Society.  
Site Co-ordinates  
17.382394, 78.512233



**Jeelan-E-Rehmath**  
@ Rahmat Kada, Saidabad Colony  
Site Co-ordinates  
17.3623847, 78.5115463



**Khan Residency**  
@ Saidabad  
Site Co-ordinates  
17.3608002, 78.5151372



**Sajida Residency**  
@ Santosh Nagar  
Site Co-ordinates  
17.346713, 78.503934



**Sofiya Residency**  
@ Santosh Nagar  
Site Co-ordinates  
17.346973, 78.504050

One More Project By:-

**SKY CASTLE DEVELOPERS**

Office Address # 18-8-252/168, Habeeb Nagar,  
Near Rakshapuram Colony, Hyderabad - 500059, T.S.

**Khalig Plaza**

KANCHANBAGH MAIN ROAD,  
HYDERABAD, TELENGANA - 500059  
Contact:- ABDUS SAML Ph:- 9391-018-916, 9849-449-922.,  
E-Mail:- Info@skycastledevelopers.com

Note : This brochure is a conceptual presentation and not a legal offering. The promoters reserve the right to make change in elevation, specifications and plans as deemed fit. All dimension to be converted into metric systems.

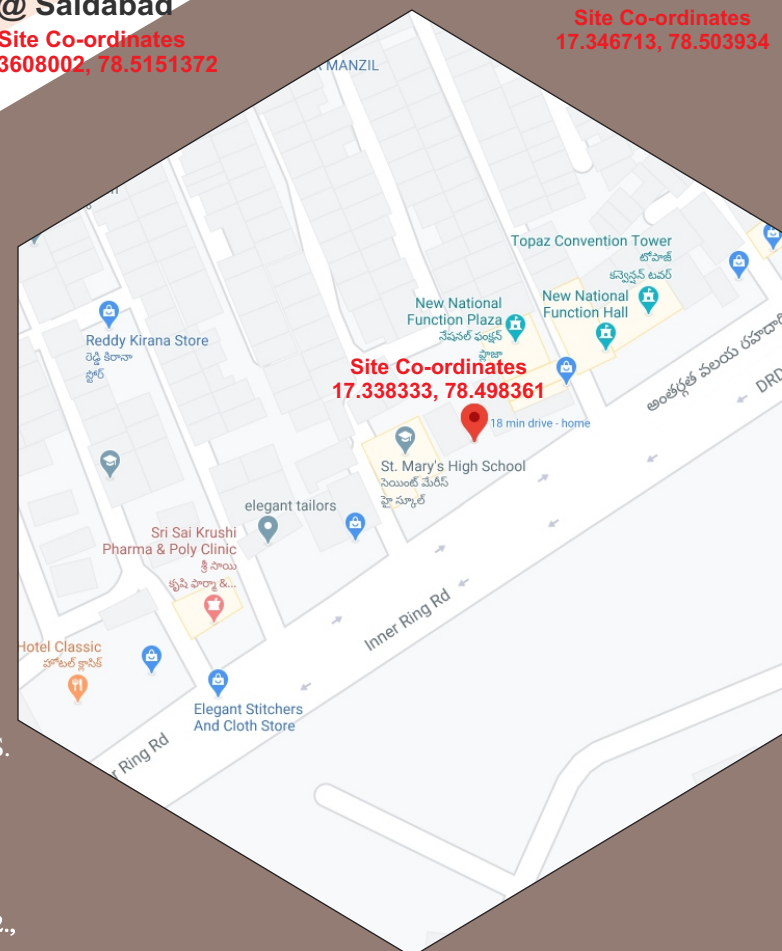

## Khalig Plaza



@  
**Kanchanbagh**

*Service with a Lifestyle.*



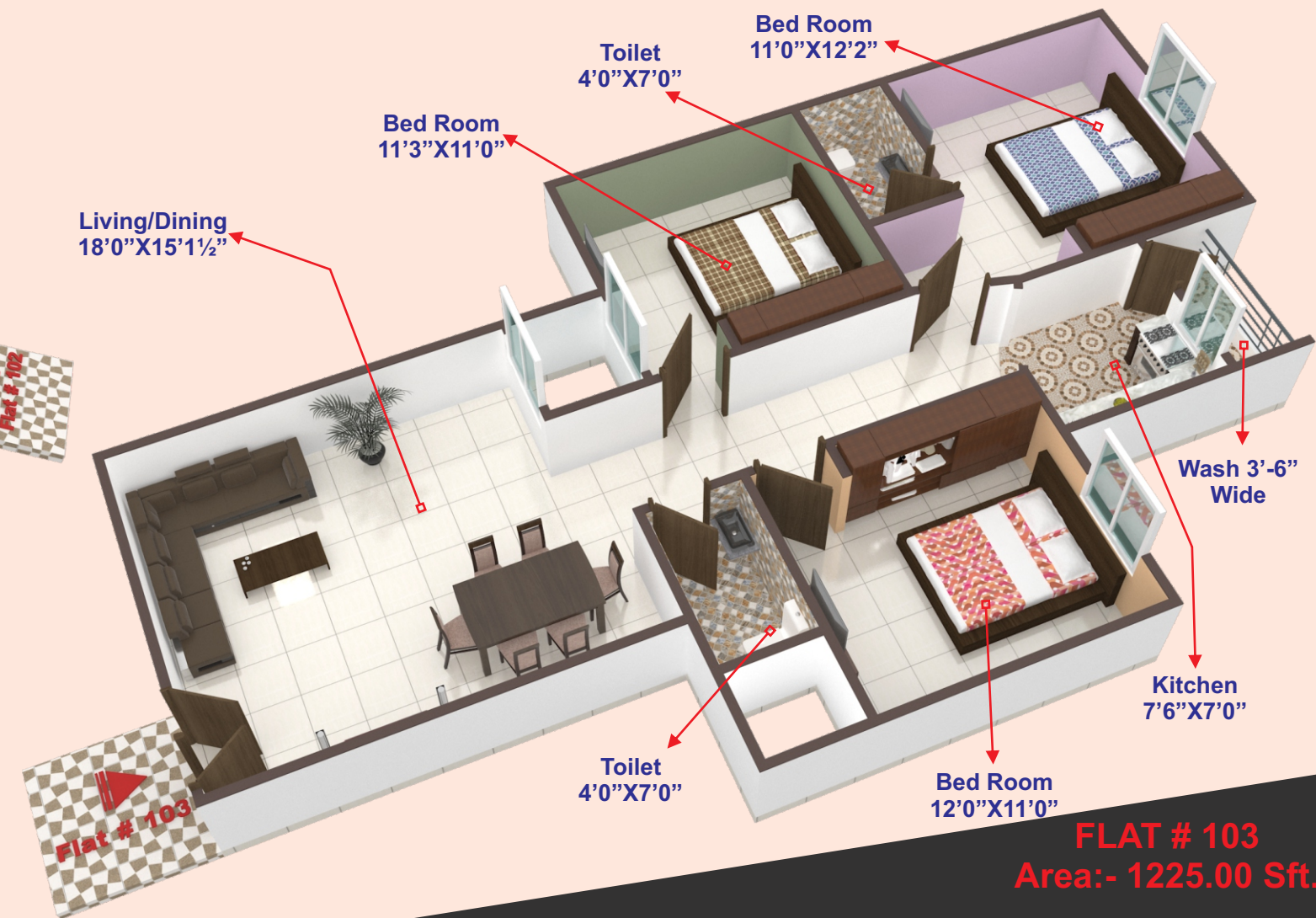
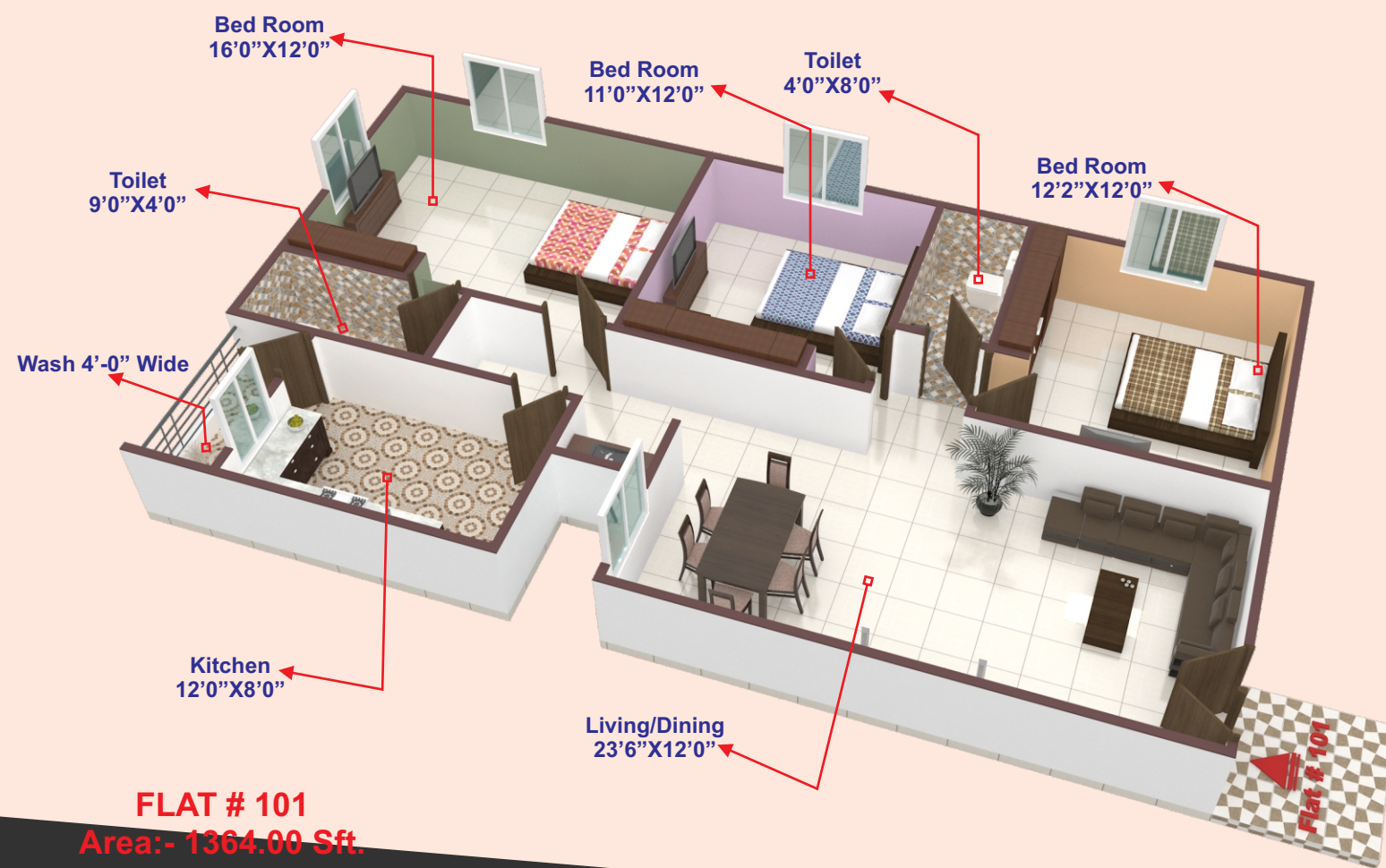

## S P E C I F I C A T I O N S : -

	<b>STRUCTURE :-</b>	Reinforced Cement Concrete as per Structural Design from Engineering Consultant, TMT fe 500,
	<b>SUPER STRUCTURE :-</b>	Solid Light weight Red Bricks or CLC Brick of 4" thickness with cement mortar for Internal and External walls. Smooth Finish with lappam for inside walls. POP ceiling for hall and drawing rooms.
	<b>DOORS :-</b>	Teak wood frames. Teak wood shutters for main door and moulded shutters for inside doors with Door knobs and Hinges fittings of Hindware.
	<b>WINDOWS :-</b>	Aluminum frames and shutters with glass and MS safety grills.
	<b>FLOORING :-</b>	Quality Marble / Vitrified Tiles for living, dining / kitchen and bedrooms. Non-skid ceramic tiles for balconies, utility area and all toilets.
	<b>TOILETS :-</b>	Ceramic tile flooring and glazed ceramic tiles for walls up to door height. Provision for geyser, exhaust fan in all toilets. All C.P. Fittings are chrome plated.
	<b>KITCHEN :-</b>	Polished granite platform, granite sink and 4 feet ceramic tiles dado with adequate RCC storage lofts. Provision for microwave oven and mixer in kitchen, washing machine point in utility.

	<b>PAINTING/ POLISHING :-</b>	Birla/ J.K. Putti finish with plastic emulsion paints for all internal walls. Main door frame and shutter polished and all other door frame and shutters with enamel paints. Premium quality Anti-fungal and water proof paint for all external walls.
	<b>ELECTRICAL :-</b>	TV point in living area and in All Three Bedrooms. Fire resistant of standard make. Electrical switches of standard make. Split A/c power point provision in master bedroom and other bedrooms.
	<b>CCTV &amp; INTERNET :-</b>	Internal Conduit wiring will be provided for CCTV for Parking area only and Internet Connection points for all the Flats.
	<b>LIFTS :-</b>	One Nos. 6-passenger's lift.
	<b>PLUMBING :-</b>	B Class P.V.C. Pipes of standard make. PVC Drainage & Storm water pipes. All plumbing points will be pressure tested.
	<b>WATER SUPPLY &amp; DRAINAGE :-</b>	Overhead tank for bore well water and municipal water.
	<b>POWER BACKUP :-</b>	Generator (Mahindra) for Common area and Lift .

## Few Words About the Project:-

A Project designed for those searching for composure. Spacious Domain only for you, Designed in artistic way in the supervision of professionals to give you complete tranquility and the bliss you were searching for Now comes to you with name **KHALIQ PLAZA**

**SKY CASTLE DEVELOPERS** in the tradition of promoter's found consistently in their other constructions. Reality seems to be bigger than dreams in **KANCHANBAGH**.